

User Guide

AroPlugin

A series of overlapping, semi-transparent, wavy lines in shades of light gray and white, creating a sense of movement and depth across the lower half of the page.

360°
AROMATICA
LUXURIOUS SCENT SURROUNDING

A decorative graphic consisting of several overlapping, wavy, light gray lines that flow horizontally across the middle of the page, creating a sense of movement and depth.

Scent
is the
revival
memories of
and.
desire

Contents

- 4 ENHANCE YOUR ATMOSPHERE
- 5 FEATURES & SPECIFICATIONS
- 6 TECHNOLOGY
- 7 DIAGRAM OF PARTS
- 8 QUICK START
- 9 WHERE TO PLACE
- 10 SETTING SCENT INTENSITY
- 11 INTENSITY CYCLES & CONSUMPTION
- 12 CLEANING THE DIFFUSER
- 13 APP CONTROL & QR CODE
- 14 WARNINGS
- 15-16 TROUBLE SHOOTING
- 17 WARRANTY AND SUPPORT

Enhance Your Atmosphere

Style your home with scent

Scent is the first thing people notice when they enter your home or business. Now you can style your home ambience with your favorite aroma oils using the most advanced scent technology. The AroPlugin will forever change the way you use scent in your home or business.

With the AroPlugin, you can create and control an exquisite scent experience adjusted perfectly to match the size and conditions of a room. You can also change the scent depending on your mood, occasions and time of day.

The AroPlugin houses cold-air nebulization technology to provide the most pure and scented environment. Our nebulization technology preserves the integrity of our premium aroma oils creating a unique and memorable experience.

Cold-air, nebulization is an easy, heat free way to diffuse Aromatica360's aroma oil blends. Aromatica360 diffusers elevate your ambience and home decor with wonderful aromas to suit your everyday lifestyle and special occasions. Aromatica360 truly creates a unique and inviting ambience in your home or business.

Features

- Revolutionary Nebulizing technology
- Bluetooth Connectivity
- App control
- Uniform and consistent scent day after day
- Constructed from recycled aluminum
- Adjustable scent intensity
- Whisper-quiet operation
- No water
- No heat
- No residue

PRODUCT NAME

COVERAGE

CONNECTIVITY

OIL CAPACITY

INPUT VOLTAGE

OUTPUT VOLTAGE

AROPugin

UP TO 90 SQ.FT

BLUETOOTH

100ML/3.5OZ MAX

110-240V AC

12V DC

Technology

Each of our fragrance nebulizers uses patented cold-air nebulizing technology to release nanoparticles into the air that leave behind no residue. This technology preserves the integrity of our aroma oils to deliver pristine, evenly distributed scent without using heat or diluting the oils in water or alcohol.

Using only Aromatica360 aroma oil blends will guarantee the best performance of your diffuser. There is no need to mix or dilute with water, carrier oils or alcohol. Our scents are produced to be used in the diffuser without alteration. Simply fill the bottle with your favorite Aromatica360 aroma oils and set the intensity.

Diagram of Parts

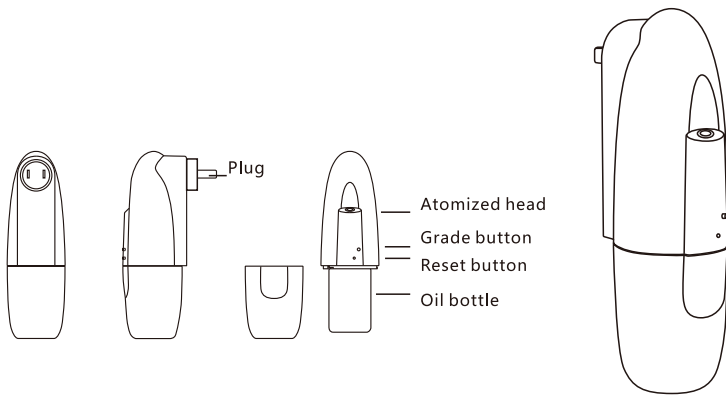

Quick start

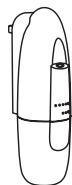

G4 G3 G2 G1



Grade



Mode

24hrs : Works 24 hours

24hrs

Smart

Smart Mode : Works with daylight or artificial light

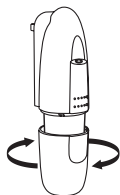

①

Twist off lower cover

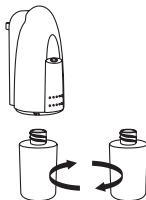

②

Screw in bottle



③

Twist on lower cover

Where to Place

LOCATION

The AroPlugin is designed to be placed in electric plug.

SCENTING COVERAGE

The AroPlugin can be adjusted to scent an area ranging from 10 to 90 sq.ft (1 to 90sq.m)

DEVICE LOCATION

An important element of your scenting experience is to properly position the device in the room to ensure optimal performance.

Choose the location where the aroma oil molecules can use the natural airflow in a room. This is particularly important with air-conditioned spaces. The best location for the AroPlugin is where there is good airflow.

Do not place the AroPlugin near an HVAC return grill, exhaust, fan, or vent. Setting near open windows will cause the scent to escape the space. Work with the natural airflow of the space.

Try a variety of locations and settings until you are happy with scent coverage. Give the AroPlugin a little time to adjust to the new location and setting before changing it again

Setting Scent Intensity

Once the Aromatica360 aroma oil is placed in the device, basic operation is simply adjusting the scent level to match the room size, ambience or occasion. Simply turn the machine on using the intensity buttons. Starting at level 1, after a few minutes, you will experience the scent spreading around your space. If needed, adjust accordingly. Once you have chosen the right setting, you should only have to adjust slightly with different aroma oils.

Keep nose clear from the scent output when the device is operating. Instead, waft air towards nose to experience the full aroma oil scent.

When changing the scent level, give the AroPlugin some time to equalize the scent level throughout the space before you decide if you need to adjust.

Aromatica360 user profiles:

Low intensity- level 1-3 / 2hrs of operation per day

Medium intensity- level 4-6 / 4 hrs of operation per day

High intensity- level 7-9 / 8-10 hrs of operation day

Intensity grade and consumption

| Grade | G1 | G2 | G3 | G4 |
|------------------------|-----|-----|----|----|
| Working time (seconds) | 15 | 15 | 15 | 15 |
| Pause time (seconds) | 285 | 135 | 85 | 60 |

- Notes: 1.The working time above of each grade is 15s.
2.Different grade and oil may be with different consumption.

*The above consumption data may vary depending on the different aroma oil

Please note that while the device is running the nebulization process, the intensity cycles turn on and off to ensure powerful scent coverage. The on/off cycle compared to a steady stream of scent allows the occupants of the space to notice the scent.

Cleaning your diffuser

Our AroPlugin, aroma oils and diffuser cleaner is a system designed to work together to provide an elevated scenting experience. In order to keep the diffuser functioning at its best, make sure to clean it every time you refill the bottle with a new scent. The nebulizer inside the diffuser can become clogged so we only recommend using our specialized aroma oils. Other oils may have thick, heavy base oils that could result in the diffuser malfunctioning. Using non Aromatica360 oils in your device will void the warranty.

1. Please keep the machine vertical. Tilt or lie flatly may cause the oil overflow. The efficiency of the machine may be affected.
2. Shall not modify, disassemble or repair the machine. If any failure happens to the machine, please contact our technical personnel.



Equipment cleaning

The machine need to be cleaned when below situation happens:

1. You're about to change another kind of essential oils
2. The atomization volume goes weak

Cleaning steps:

1. Unscrew the lower cover and take out the oil bottle
2. Find a larger container and fill the industrial alcohol up. Then soak the bottle for 5-10 minutes.
3. Airing the bottle.

WARNINGS

- Only use the power adapter supplied with the device.
- Never operate the diffuser if the power adapter is damaged.
- Do not use the diffuser if any part of the device is broken.
- NEVER attempt to service, disassemble, or repair the device in anyway, other than cleaning and refilling the Aroma oil bottle.
- When moving the device always keep it upright, do not tilt and carry securely with both hands.
- Always place unit on a stable, level surface and ensure it is over 2' away from the ceiling.
- NEVER dilute oils with water or carrier oils.
- NEVER pour water in or on the device and never operate with wet hands.
- Do not cover the device with objects or material while in use.
- Ensure power adapter is never blocked when plugged in.
- Keep nose clear from the scent output at the top of the diffuser when the device is operating.
- ALWAYS keep out of reach of small children and pets.
- Store at room temperature 68-75 F (20-23 C), 30-35% Humidity

In the event of a problem or issue, please contact us at
or info@aromatica360.com

Trouble shooting

Before having the machine repaired, please try to diagnose the problem first with the bellow instructions

| Symptom | Remedy |
|------------------|---|
| Does not diffuse | <ul style="list-style-type: none">- Whether the machine is in "not working period". If yes, it won't spray.- Check whether the air pump is damaged. If yes, replace it with a new one. |
| Spray little | <ul style="list-style-type: none">- Check whether the gasket is damaged or loose. Please adjust it or replace it with a new one.- Check whether the atomized core is plugged; clear it with alcohol or replace it with a new one |
| Oil spill | <ul style="list-style-type: none">- Check whether the atomized head is damaged |
| Oil overflow | <ul style="list-style-type: none">- Check whether the oil bottle is loose, please install it correctly- Check whether the gasket of the atomized head is damaged; if yes, please replace it with another one.- Please keep the machine vertical; Tilt or lie flatly will cause the oil overflow |

| Symptom | Possible cause | Solution |
|---|---|--|
| Diffuser does not connect to Scenting App. | <ol style="list-style-type: none"> Someone else is connected via Bluetooth to your device. Phone is too far away from diffuser. | Reset the diffuser by holding down the power button till you hear 2 beeps. Reconnect to Bluetooth via the app on your phone. |
| Diffuser is on but it is making a gurgling noise. | <ol style="list-style-type: none"> The bottle is filled too high. | <ol style="list-style-type: none"> Make sure the oil does not exceed the max fill line. |
| The diffuser turned off by itself, no blue light on the base, no intensity level showing. | <ol style="list-style-type: none"> The diffuser is designed to cycle the pump on and off and mists intermittently. The time of the day is outside of the scheduled operating periods. | <ol style="list-style-type: none"> Turn your diffuser on and then wait a full cycle, 10 min. Diffuser light turns off during normal running cycle. Check scheduling in the Scenting App. |
| Unusual or loud noise | | Turn diffuser off and contact customer care Info@aromatica360.com |
| PLEASE Contact customer care for any questions or concerns that may arise. | | |

Warranty and Support

All products designed by AromTech come with a 1-year limited warranty. Failure to use Aromatica360 branded oils may cause your diffuser to malfunction or not diffuse properly in which case warranty will be void. If you have any questions or issues please reach out to our customer care experts:

info@aromatica360.com

360°
AROMATICA
LUXURIOUS SCENT SURROUNDING

aromatica360.COM

info@aromatica360.com